

HL Series LED Heliport Beacon Light

Heliport light LED beacon is used to a heliport where long range visual guidance is considered necessary; Or identification of the heliport is difficult due to surrounding lights. The light shall be located on or adjacent to the heliport preferably at an elevated position and so that it does not dazzle a pilot at short distance.

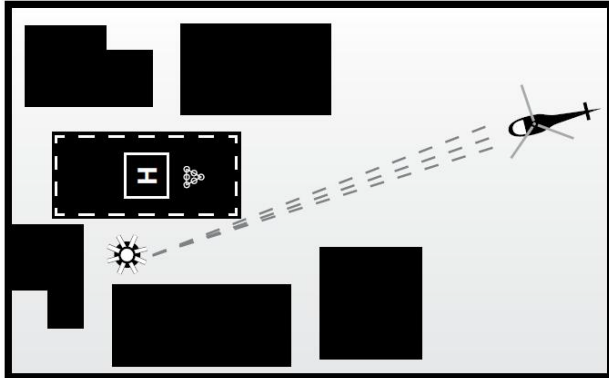

Optical:

Elevation angle	Azimuth	Light Intensity
10°	-180° to 180°	>250cd
7°	-180° to 180°	>750cd
4°	-180° to 180°	>1700cd
2.5°	-180° to 180°	>2500cd
1.5°	-180° to 180°	>2500cd
0°	-180° to 180°	>1700d

Mounting:

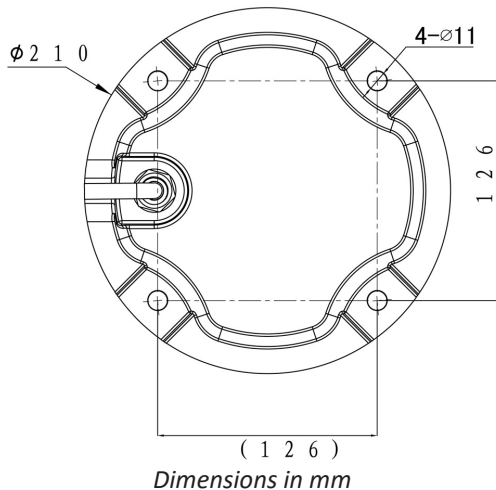

Manufacture Standard:

- ICAO Annex 14, Volume II, 4th Edition, July, 2013

Technical Features:

- Operation voltage: 100V~250V AC, 50HZ/60HZ.
- Lamp: 50,000 hours LED lifespan.
- Output: Omnidirectional.
- Watts: 15Watts.
- Lighting protection level: 15KA max.

Construction & Physical:

- Housing: aluminum alloy.
- Lamp Cover: Impact resistant polycarbonate.
- Overall size $\phi 21\text{cm} \times 14\text{cm}$ ($\phi 8.2'' \times 5.5''$).
- IP rating: IP65.
- Weight: 3KG.
- Operating: -40°C to 60 °C.
- Wind speed: 80m/s.

Ordering Code:

Type	Output	Lamp	Control
12A	W: White WGY ¹	AC: 100/250V DC: 10/30V	VB ²

¹ White-Green-Yellow three color omnidirectional alternate flashes.
² Variable brightness, 3 level brightness controlled.